

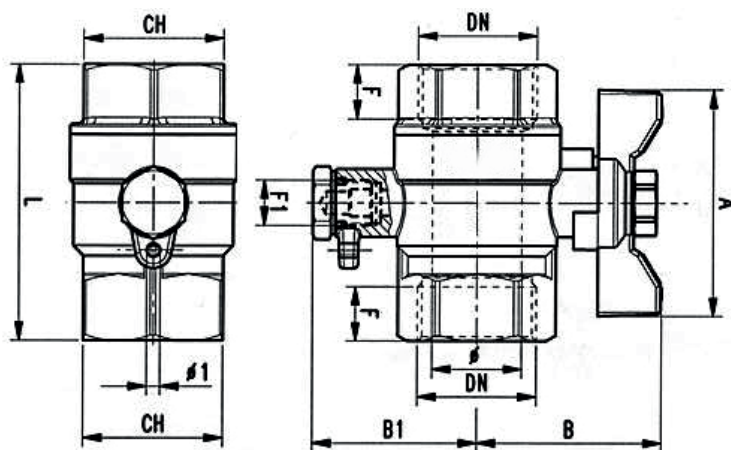

mod. **V-15 / V-20 / V-25**

Valvola a sfera con pozzetto M10 predisposta per l'installazione diretta su sonde Hydrocal-M3.

*Ball valve with no socket pre-equipped for the connection of the Hydrocal-M3 temperature probes.*



Corpo in ottone CW617N nichelato - *Nickel plated CW617N brass body*  
Filettature ISO228 - *ISO228 threads*

DN	15	20	25
in	1/2"	3/4"	1"
L	50,5	61	66
B	37,5	41	43,5
B1	36,5	36,5	36,5
F	10,5	12	15
F1	M10 x1	M10 x1	M10 x1
ø1	3	3	3
CH	25	31	37
A	50	50	70
Peso - <i>Weight</i>	200	290	410

Lunghezze in mm - *Lengths in mm*  
Pesi in g - *Weights in g*